

St Albans Road

S M E T H W I C K

For Sale

**3 Bedroom
Terraced House**



SOUL ESTATES

SALES & LETTINGS



FOR SALE

3 Bedroom Terraced House

The finer details

- 🏠 A BEAUTIFULLY PRESENTED MID-TERRACED FAMILY HOME
- 🏠 INVESTMENT OPPORTUNITY OR FIRST TIME BUYERS
- 🏠 THREE GOOD SIZE BEDROOMS
- 🏠 TWO RECEPTION ROOMS
- 🏠 FITTED KITCHEN
- 🏠 FAMILY BATHROOM
- 🏠 GOOD SCHOOLS & LOCAL AMENITIES
- 🏠 SOUGHT AFTER LOCATION

Description

Soul Estates are proud to present this well-presented 3-bedroom mid-terraced house For Sale. This perfect family home is situated in a very popular area of Smethwick providing an excellent for first-time buyers or investment opportunities, with good schools situated close by. The house is close to Smethwick Galton Bridge Train Station, Holly Lodge High School and Smethwick High Street.

The property offers an entrance hall with rooms going off to the spacious reception room followed by the lounge, kitchen and family bathroom to the rear. Fitted family kitchen with a range of wall and base units to match, splashback tiling, a free-standing cooker and a boiler.

Stairs leading to the first-floor landing which leads off to two double bedrooms and a large single bedroom. The property also benefits from gas central heating and double glazing, a good-sized rear garden and low maintenance front garden with ample on-street parking.





ENTRANCE HALL:
8' 7" x 2' 7" (2.61m x 0.79m)

RECEPTION:
11' 4" x 9' 5" (3.45m x 2.87m)

LOUNGE:

11' 3" x 12' 5" (3.43m x 3.78m)

KITCHEN:

10' 5" x 7' 3" (3.17m x 2.21m)





BATHROOM:

6' 2" x 6' 10" (1.88m x 2.08m)

LANDING:

17' 01" x 2' 7" (6.85m x 0.79m)

BEDROOM 1:

11' 3" x 12' 8" (3.43m x 3.86m)

BEDROOM 2:

11' 3" x 9' 5" (3.43m x 2.87m)

BEDROOM 3:

10' 5" x 7' 4" (3.17m x 2.23m)





Ground Floor

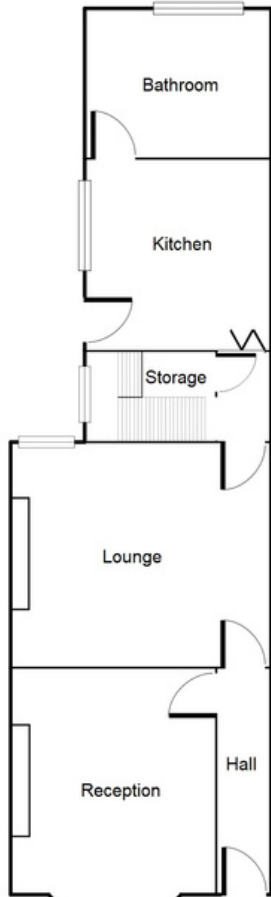

This floorplan is just an example this is not to scale.
Please see description for exact room sizes.
(c) Soul Estates

**GROUND FLOOR
FLOORPLAN**

First Floor

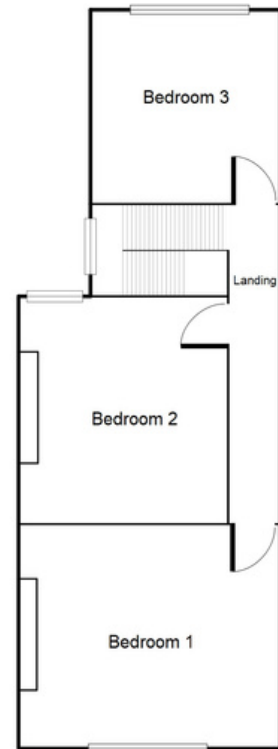

This floorplan is just an example this is not to scale.
Please see description for exact room sizes.
(c) Soul Estates

**FIRST FLOOR
FLOORPLAN**

St Albans Road

S M E T H W I C K



SOUL ESTATES
SALES & LETTINGS

CONTACT US

Soul Estates
20 Great Bridge
Tipton
DY4 7HA

0121 647 6779

www.soulestates.co.uk

